

### NTL-F152: Exit Filter

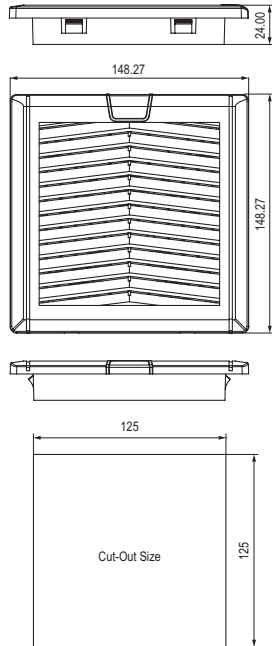

### NTL-FF152: Filter Fan



### Product Applications:

Our products are widely used in the control panels, junction boxes, power distribution box, automation equipment, electronic and power device, welding machine, packing and

Normal Color: RAL 7035, RAL 7032, (other color can be customer made)

Patent Number: ZL 2019 3 0322398.4

### Technical Data

#### NTL-FF152

Axial fan, ball bearing	service life L10 at +40°C (+104°F): min. 37,000 h fan body aluminium, rotor metal
Connection	2 stranded wires, 160mm
Enclosure cut-out	125 x 125mm
Mounting frame	Screw Fixing Type, Easy to open the cover
Filter mat	G4 acc. to DIN EN 779, filtering degree 94%
Filter material	New ABS material confirm to RoHS, Fireproof or not fireproof can be choose
Operating/Storage temperature	-40 to +70°C (-40 to +158°F)
Operating/Storage humidity	max. 90% RH (non-condensing)
Protection type/Protection class	IP54 / I (earthed)
Note	other voltages on request

### Technical Parameters

Model	Power Supply	Net Weight (kg)	Fan Size Matched (mm)	Air Flow Rate (free blow) (m³/h)	Power Consumption (W)	Current Consumption (A)	Noise Level (dBA)	Dimensions (mm)
NTL-F152	-	0.111	without fan	-	-	-	-	149×149×24
NTL-FF152-230A	230VAC	0.47	120×120×25	96/112	14/12	0.07	39/42	149×149×59
NTL-FF152-230B	230VAC	0.58	120×120×38	138/162	19/15	0.11/0.15	43/48	149×149×72
NTL-FF152-115A	115VAC	0.47	120×120×25	96/112	14/12	0.07	39/42	149×149×59
NTL-FF152-115B	115VAC	0.58	120×120×38	138/162	19/15	0.11/0.15	43/48	149×149×72
NTL-FF152-12	12VDC	0.4	120×120×38	180	7	0.5	48	149×149×72
NTL-FF152-24	24VDC	0.4	120×120×38	180	7.2	0.6	48	149×149×72

Normally is airflow direction "Out", if you need airflow direction "In", when place order, please advice.

### NTL-F255: Exit Filter

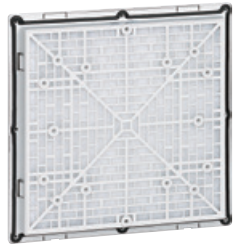

### NTL-FF255: Filter Fan

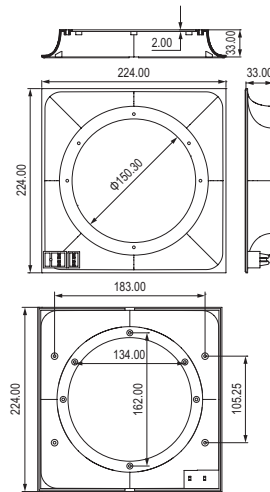
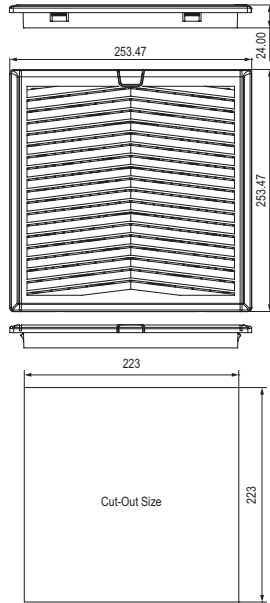

861002

### Product Applications:

Our products are widely used in the control panels, junction boxes, power distribution box, automation equipment, electronic and power device, welding machine, packing and

Normal Color: RAL 7035, RAL 7032, (other color can be customer made)

Patent Number: ZL 2019 3 0322398.4

### Technical Data

NTL-FF255	
Axial fan, ball bearing	service life L10 at +40°C (+104°F): min. 56,000h rotor metal
Connection	3-pole clamp for 2.5mm <sup>2</sup> , clamping torque 0.8Nm max.
Enclosure cut-out	223 x 223mm
Mounting frame	Screw Fixing Type, Easy to open the cover
Filter mat	G4 acc. to DIN EN 779, filtering degree 94%
Filter material	New ABS material confirm to RoHS, Fireproof or not fireproof can be choose
Operating/Storage temperature	-25 to +65°C (-13 to +149°F) / -40 to +70°C (-40 to +158°F)
Operating/Storage humidity	max. 75% RH (non-condensing)
Protection type/Protection class	IP54 / I (earthed)

### Technical Parameters

Model	Power Supply	Net Weight (kg)	Fan Size Matched (mm)	Air Flow Rate (free blow) (m <sup>3</sup> /h)	Power Consumption (W)	Current Consumption (A)	Noise Level (dBA)	Dimensions (mm)
NTL-F255	-	0.301	without fan	-	-	-	-	254×254×89
NTL-FF255-230A	230VAC	1.14	Φ172×55	272/316	31/28	0.24/0.22	52/62	254×254×84
NTL-FF255-230B	230VAC	1.15	170×150×50	272/316	31/28	0.24/0.22	52/62	254×254×94
NTL-FF255-230C	230VAC	1.15	Φ220×60	800/1000	48/63	0.23/0.28	63/66	254×254×94
NTL-FF255-230D	230VAC	1.6	200×200×60	800/1000	48/63	0.23/0.28	63/66	254×254×89
NTL-FF255-230EF	230VAC	1.3	Φ172×55	272/316	31/28	0.24/0.22	52/62	254×254×84
NTL-FF255-230FF	230VAC	1.31	170×150×50	272/316	31/28	0.24/0.22	52/62	254×254×99
NTL-FF255-230GF	230VAC	1.7	180×180×65	586/671	42/50	0.2/0.24	63/68	254×254×89
NTL-FF255-115A	115VAC	1.14	Φ172×55	272/316	31/28	0.47/0.405	52/62	254×254×84
NTL-FF255-115B	115VAC	1.15	170×150×50	272/316	31/28	0.47/0.405	52/62	254×254×94
NTL-FF255-115C	115VAC	1.15	Φ220×60	800/1000	48/63	0.42	63/66	254×254×94
NTL-FF255-115D	115VAC	1.6	200×200×60	700/800	48/63	0.42	63/68	254×254×89
NTL-FF255-115EF	115VAC	1.3	Φ172×55	272/316	31/28	0.47/0.405	52/62	254×254×84
NTL-FF255-115FF	115VAC	1.31	170×150×50	272/316	31/28	0.47/0.405	52/62	254×254×99
NTL-FF255-115GF	115VAC	1.7	180×180×65	586/671	42/50	0.42	63/68	254×254×84
NTL-FF255-12A	12VDC	1	170×150×50	374.64	7.8	0.65	62	254×254×94
NTL-FF255-12B	12VDC	1.8	200×200×60	1008	24	2	68	254×254×84
NTL-FF255-24A	24VDC	1	170×150×50	374.64	9.6	0.4	62	254×254×94
NTL-FF255-24B	24VDC	1.8	200×200×60	1008	20.88	0.87	68	204×204×84

Normally is airflow direction "Out", if you need airflow direction "In", when place order, please advice.

### NTL-F323: Exit Filter



### NTL-FF323: Filter Fan

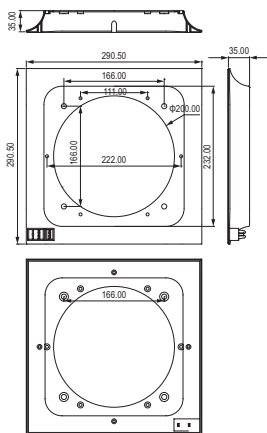
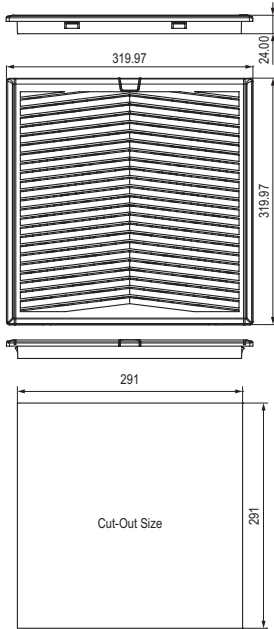

861003

### Product Applications:

Our products are widely used in the control panels, junction boxes, power distribution box, automation equipment, electronic and power device, welding machine, packing and

Normal Color: RAL 7035, RAL 7032, (other color can be customer made)

Patent Number: ZL 2019 3 0322398.4

### Technical Data

#### NTL-FF323

Axial fan, ball bearing	service life L10 at +40°C (+104°F): min. 56,000h rotor metal
Connection	3-pole clamp for 2.5mm <sup>2</sup> , clamping torque 0.8Nm max.
Enclosure cut-out	291 x 291mm
Mounting frame	Screw Fixing Type, Easy to open the cover
Filter mat	G4 acc. to DIN EN 779, filtering degree 94%
Filter material	New ABS material confirm to RoHS, Fireproof or not fireproof can be choose
Operating temperature	50 Hz: -25 to +55°C (-13 to +131°F) 60 Hz: -25 to +35°C (-13 to +95°F)
Storage temperature	-40 to +70°C (-40 to +158°F)
Operating/Storage humidity	max. 75% RH (non-condensing)
Protection type/Protection class	IP54 / I (earthed)
Note	other voltages on request

### Technical Parameters

Model	Power Supply	Net Weight (kg)	Fan Size Matched (mm)	Air Flow Rate (free blow) (m <sup>3</sup> /h)	Power Consumption (W)	Current Consumption (A)	Noise Level (dBA)	Dimensions (mm)
NTL-F323	-	0.425	without fan	-	-	-	-	320×320×94
NTL-FF323-230A	230VAC	1.87	200×200×60	700/800	48/63	0.23/0.28	63/68	320×320×94
NTL-FF323-230BF	230VAC	2.09	200×200×60	700/800	48/63	0.23/0.28	63/68	320×320×94
NTL-FF323-230CF	230VAC	1.96	Φ220×60	800/1000	48/63	0.23/0.28	63/66	320×320×114
NTL-FF323-230DF	230VAC	2.86	225×225×80	1000/1150	70/80	0.33/0.35	63/66	320×320×114
NTL-FF323-230E	230VAC	3.9	280×280×80	1200/1400	120/160	0.5/0.7	65/70	320×320×94
NTL-FF323-115A	115VAC	1.87	200×200×60	700/800	48/63	0.42	63/68	320×320×94
NTL-FF323-115BF	115VAC	2.09	200×200×60	700/800	48/63	0.42	63/68	320×320×94
NTL-FF323-115CF	115VAC	1.96	Φ220×60	800/1000	48/63	0.42	63/66	320×320×114
NTL-FF323-115DF	115VAC	2.86	225×225×80	1000/1150	70/80	0.65/0.70	63/66	320×320×114
NTL-FF323-115E	115VAC	3.9	280×280×80	1200/1400	120/160	1.0/1.4	65/70	320×320×94
NTL-FF323-12	12VDC	2.01	200×200×60	1008	24	2	68	320×320×94
NTL-FF323-24	24VDC	2.01	200×200×60	1008	20.88	0.87	68	204×204×84

Normally is airflow direction "Out", if you need airflow direction "In", when place order, please advice.